

1 LEVEL 1 - DEMOLITION POWER AND COMMUNICATIONS PLAN - EAST SIDE
E200 1 : 50

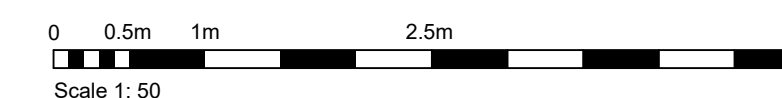

Stantec Consulting Ltd.
1100-111 Dunsmuir Street
Vancouver, BC V6B 6A3
Tel: (604) 696-8000 • www.stantec.com

Copyright Reserved

The Contractor shall verify and be responsible for all dimensions. DO NOT scale the drawing - any errors or omissions shall be reported to Stantec without delay. The Copyrights to all designs and drawings are the property of Stantec. Reproduction or use for any purpose other than that authorized by Stantec is forbidden.

Consultant

Notes

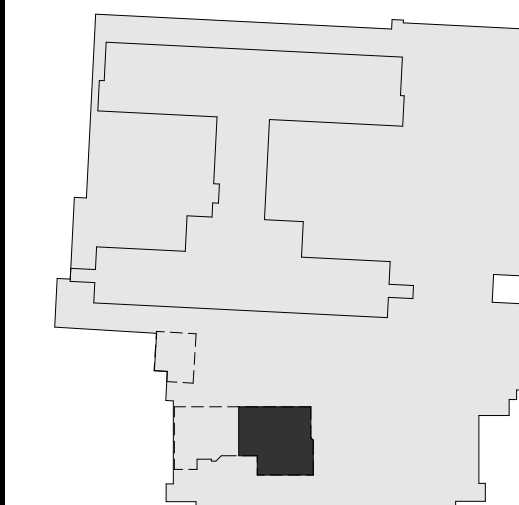
[illegible]

File Name: N/A

Dwn. Dsan. Chkd. YYYY.MM

Permit/Seal

Client/Project Logos



Client/Project
Northern Health

UHN - Cardiac Diagnostic Services - Phase 3

1475 Edmonton St, Prince George, BC V2M 1S2

Title
LEVEL 1 - POWER &
COMMUNICATIONS DEMO - EAST
SIDE

Project No.
144320012

Scale
As indicated

Drawing No.

E200

L200

File Name: N/A

Permit/Seal

Client/Project Logos



Client/Project
Northern Health

UHN - Cardiac Diagnostic Services - Phase 3

1475 Edmonton St, Prince George, BC V2M 1S2

Title
LEVEL 1 - POWER &
COMMUNICATIONS DEMO - WEST
SIDE

Project No. 144320012	Scale As indicated
Revision 4	Drawing No. E201

E201

Click location in Project Information>
On Feb. 25 3:50PM

ORIGINAL SHEET - ARCH D



GENERAL NOTES

1. REFER TO GENERAL NOTES ON DRAWING E001.
2. PROVIDE ELECTRICAL JUNCTION BOX FOR PLUMBING FIXTURE WHERE CIRCUITING IS INDICATED. COORDINATE ELECTRICAL REQUIREMENTS & BOX LOCATION WITH MECHANICAL CONTRACTOR PRIOR TO COMMENCING WORK. STANTEC RECOMMENDS MECHANICAL CONTRACTOR PROVIDE LOW VOLTAGE TRANSFORMERS AS NEEDED FOR PLUMBING FIXTURES.
3. PROVIDE HEAT TRACE POWER CONNECTIONS ON HOT WATER PIPES. PIPING SHOWN ON MECHANICAL DRAWINGS. COORDINATE WITH MECHANICAL CONTRACTOR.
4. FOR NEW DATA CABLEING, ORIGIN POINT TO BE DATA CLOSET '1CC'1 IN ROOM NUMBER 1597. PROVIDE NEW 48 PORT PATCH PANEL MOUNTED IN EXISTING RACK AND PROVIDE TERMINATIONS TO PATCH PANEL. MANUFACTURE TO MATCH THE TYPE IN THE EXISTING FACILITY. CONTRACTOR TO INCLUDE 3 PATCH CABLES EACH AT THE IT RACK, AND 6 AT EACH WORKSTATION. ALL DATA CABLE TO BE CAT6A, TX6A VARI-MATRIX CMR UTP PURSAV04 PATCH CORDS; PANDUIT CAT 6A TX6A UTP UTP6AX. ALL INSTALLATION AND TESTING SHALL BE INCLUDED IN CONTRACT, AS WELL AS ALL ACCESSORIES.
- ALL NETWORK CABLE SHALL BE IN EXISTING CABLE TRAY OR IN NEW CONDUIT. NO J-HOOK ALLOWED UNLESS WHERE APPROVED BY HOSPITAL FACILITIES MAINTENANCE (FM).
5. COORDINATE WITH OWNER ON SITE FOR EXACT REQUIREMENTS.
6. PROVIDE ROOM REFERENCE BOND BOX FOR ALL PATIENT CARE ENVIRONMENTS.
7. FEEDER CONDUCTORS TO EXISTING PANELS MAY NOT HAVE LENGTH REQUIRED FOR NEW PANEL LOCATIONS. PRESUME THAT FEEDERS WILL NEED TO BE REPLACED AND CREDIT OWNER LATER IN PROJECT IF EXISTING FEEDERS ARE USABLE. REFER TO SPECIFICATIONS APPENDIX DRAWINGS.
8. THE INTENT OF PUBLIC ANNOUNCEMENT (PA) SPEAKERS IS TO RE-USE THE DEMOLISHED SPEAKERS IN NEW RELOCATED POSITIONS & RE-USE EXISTING PA CIRCUITS. IF THE PA SPEAKERS CANNOT BE RE-USED, INFORM NORTHERN HEALTH & CONSULTANT.
- FOR ANY NEW PA SPEAKERS, USE BOGEN-S810725PG8W ON EXISTING PA SPEAKER CIRCUIT. ALLOW SPEAKERS TO BE WIRED TO PA SYSTEM HEAD END IN DATA ROOM OUTSIDE PEDIATRICS DEPARTMENT. CONTRACTOR TO CONFIRM ON SITE.
9. ALL RECEPTACLES TO BE HEAVY DUTY HOSPITAL GRADE. COLOR TO MATCH EXISTING HOSPITAL STANDARD.
10. CONTRACTOR TO COORDINATE PATIENT CARE RECEPTACLES MOUNTING HEIGHT AND EXACT LOCATION ON SITE PRIOR ROUGH-IN.

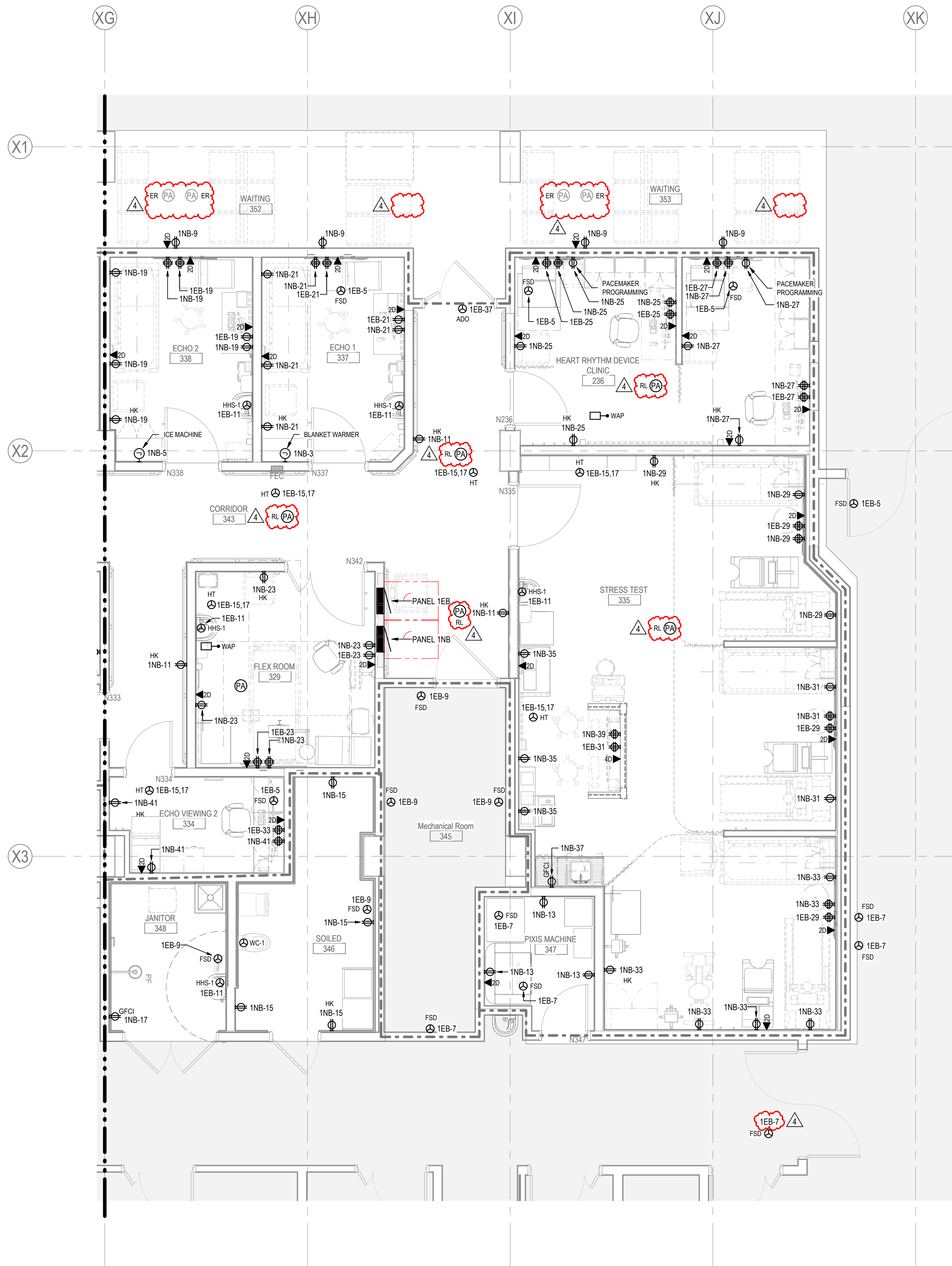

1
E300
LEVEL 1 - NEW POWER AND COMMUNICATIONS PLAN - EAST SIDE
1 : 50

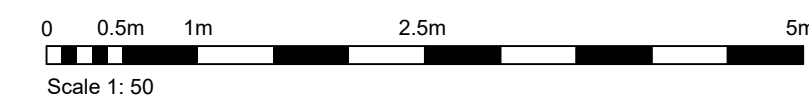

Stantec Consulting Ltd.
1100-111 Dunsmuir Street
Vancouver, BC V6B 6A3
Tel: (604) 696-8000 • www.stantec.com

Copyright Reserved

The Contractor shall verify and be responsible for all dimensions. DO NOT scale the drawing - any errors or omissions shall be reported to Stantec without delay.
The Copyrights to all designs and drawings are the property of Stantec. Reproduction or use for any purpose other than that authorized by Stantec is forbidden.

Consultant

Notes

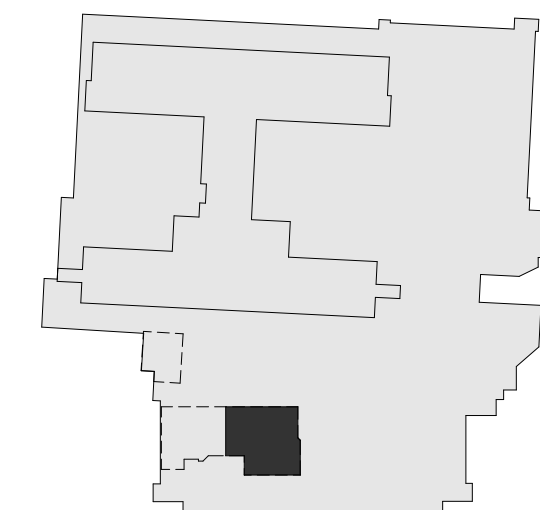

4	ISSUED FOR ADDENDUM 2	CC	TF	2025.02.21
3	ISSUED FOR BP	CC	TF	2025.02.05
2	ISSUED FOR TENDER	CC	TF	2025.01.27
1	ISSUED FOR 100% & QS	CC	CC	2024.11.24
Issued/Revision		By	Appd	YYYY.MM.DD

File Name: N/A
Dwn. Dsgn. Chkd. YYYY.MM.DD

Permit/Seal

Client/Project Logo



Client/Project
Northern Health

UHN - Cardiac Diagnostic Services - Phase 3

1475 Edmonton St, Prince George, BC V2M 1S2

Title
LEVEL 1 - POWER & COMMUNICATIONS NEW - EAST SIDE

Project No.
144320012
Revision
4

Scale
As indicated
Drawing No.
E300

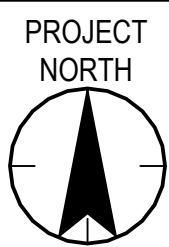

GENERAL NOTES

1. REFER TO NOTES ON DRAWING E001 AND E300.



Stantec Consulting Ltd.
1100-111 Dunsmuir Street
Vancouver, BC V6B 6A3
Tel: (604) 696-8000 • www.stantec.com

Copyright Reserved

The Contractor shall verify and be responsible for all dimensions. DO NOT scale the drawing - any errors or omissions shall be reported to Stantec without delay.
The Copyrights to all designs and drawings are the property of Stantec. Reproduction or use for any purpose other than that authorized by Stantec is forbidden.

Consultant

Notes

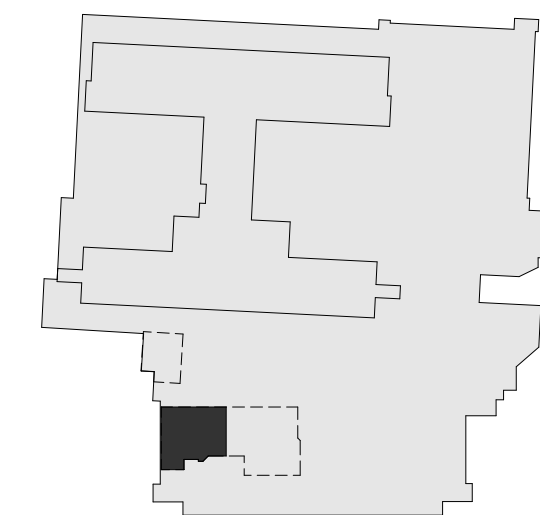

4	ISSUED FOR ADDENDUM 2	CC	TF	2025.02.21
3	ISSUED FOR BP	CC	TF	2025.02.05
2	ISSUED FOR TENDER	CC	TF	2025.01.27
1	ISSUED FOR 100% & QS	CC	CC	2024.11.24
Issued/Revision		By	Appd	YYYY.MM.DD
File Name: N/A				
		Dwn.	Dsgn.	Chkd.
				YYYY.MM.DD

Permit/Seal

Client/Project Logo



Client/Project
Northern Health

UHN - Cardiac Diagnostic Services - Phase 3

1475 Edmonton St, Prince George, BC V2M 1S2

Title

LEVEL 1 - POWER &
COMMUNICATIONS NEW - WEST SIDE

Project No.
144320012

Revision
4

Scale
As indicated

Drawing No.
E301

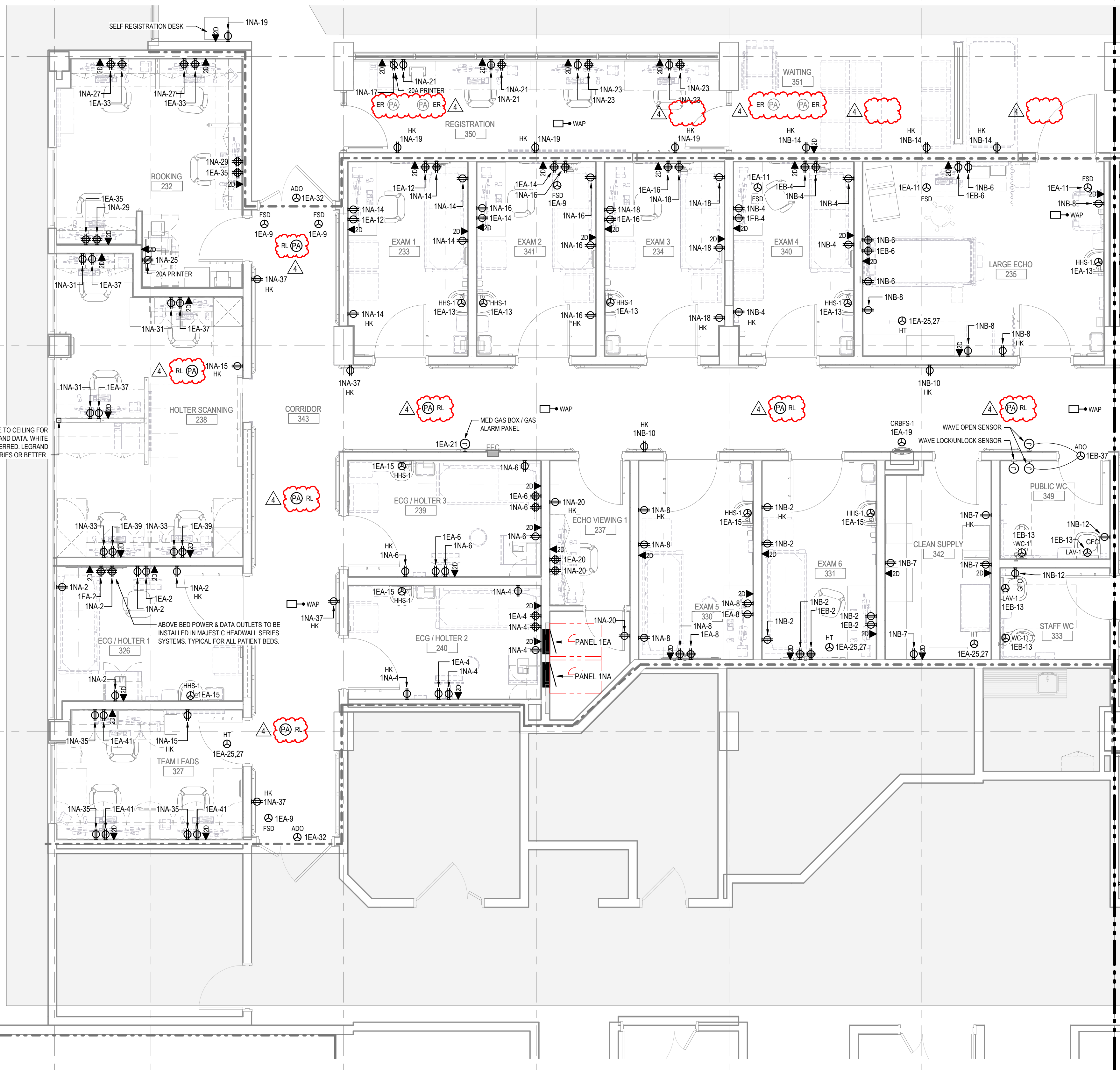
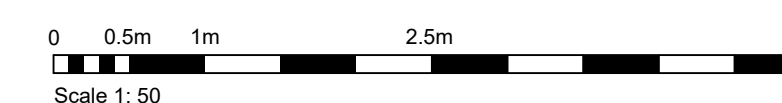

1 LEVEL 1 - NEW POWER AND COMMUNICATIONS PLAN - WEST SIDE

1:50

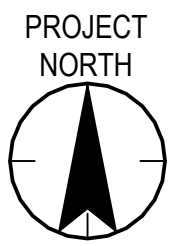

GENERAL NOTES

1. REFER TO NOTES ON DRAWING E001 AND E300.



Stantec Consulting Ltd.
1100-111 Dunsmuir Street
Vancouver, BC V6B 6A3
Tel: (604) 696-8000 • www.stantec.com

Copyright Reserved

The Contractor shall verify and be responsible for all dimensions. DO NOT scale the drawing - any errors or omissions shall be reported to Stantec without delay.
The Copyrights to all designs and drawings are the property of Stantec. Reproduction or use for any purpose other than that authorized by Stantec is forbidden.

Consultant

Notes

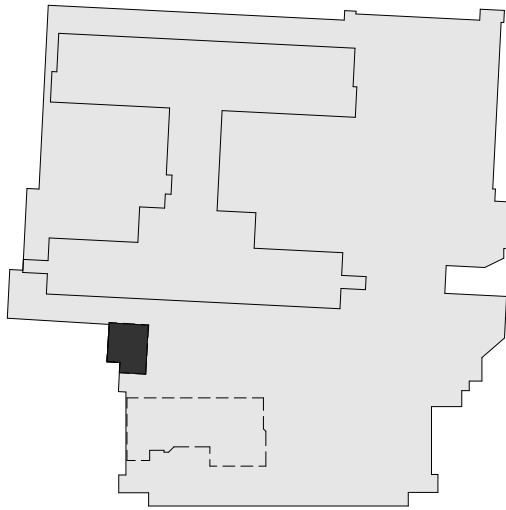

4	ISSUED FOR ADDENDUM 2	CC	TF	2025.02.21
3	ISSUED FOR BP	CC	TF	2025.02.05
2	ISSUED FOR TENDER	CC	TF	2025.01.27
1	ISSUED FOR 100% & QS	CC	CC	2024.11.24
Issued/Revision		By	Appd	YYYY.MM.DD
File Name: N/A		Dwn.	Dsgn.	Chkd. YYYY.MM.DD

Permit/Seal

Client/Project Logo



Client/Project
Northern Health

UHN - Cardiac Diagnostic Services - Phase 3

1475 Edmonton St, Prince George, BC V2M 1S2

Title
LEVEL 1 - POWER &
COMMUNICATIONS NEW - NORTH
SIDE

Project No.
144320012

Revision
4

Scale
As indicated

Drawing No.

E302

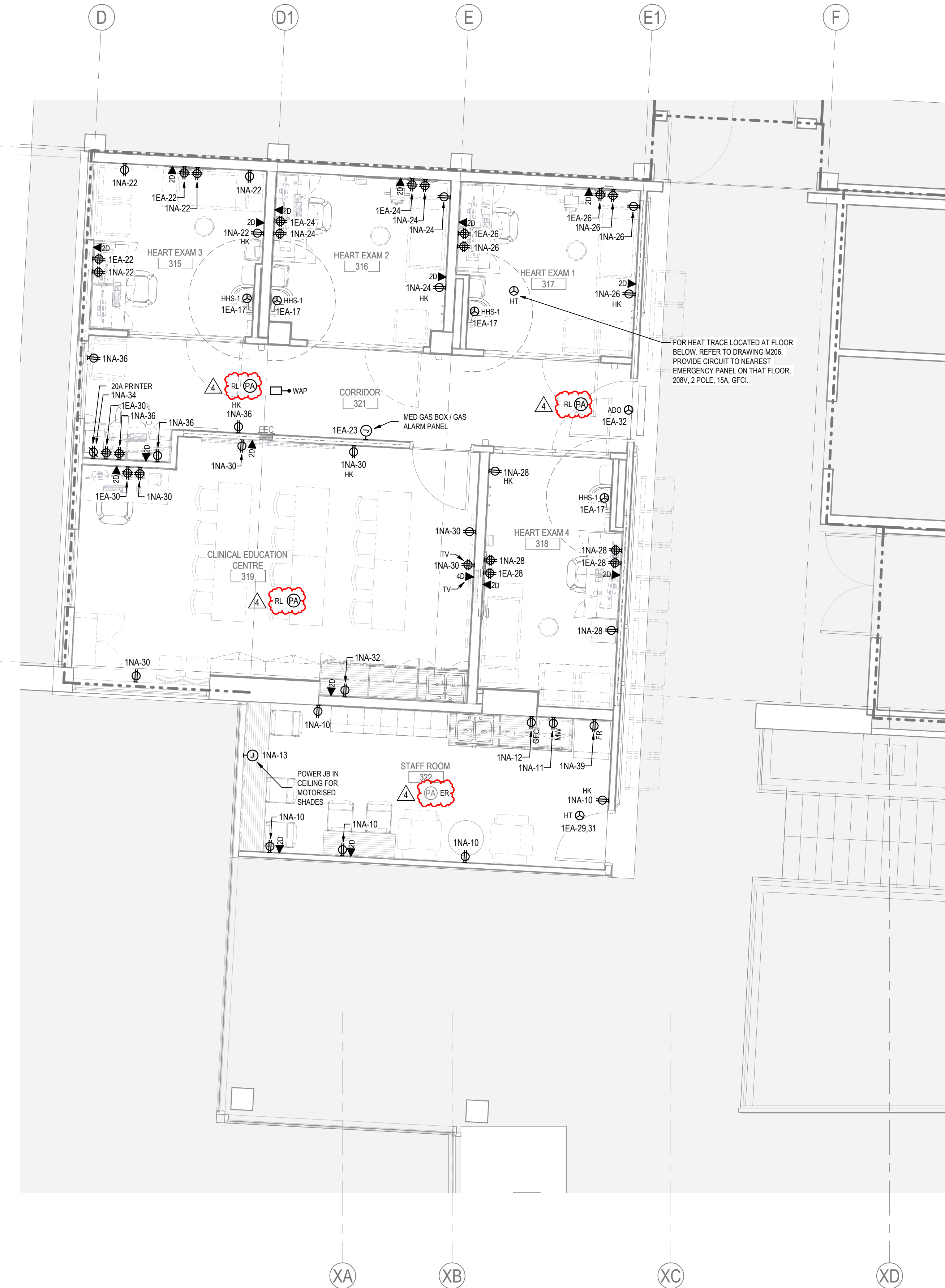

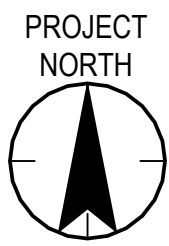

GENERAL NOTES

1. REFER TO GENERAL NOTES ON DRAWING E001.
2. PROVIDE SMOKE DETECTORS FOR FIRE/SMOKE DAMPERS PER CAN ULC S524. REFER TO MECHANICAL DRAWINGS M101, M102, M103 FOR FIRE/SMOKE DAMPER LOCATIONS. CONNECT DAMPERS TO FIRE ALARM SYSTEM PER ELECTRICAL SPECIFICATIONS.

BCBC 2024 3.1.8.11 3) INDICATES SMOKE DETECTOR PLACEMENT AT FIRE SEPARATIONS.
3. REFER TO MECHANICAL SPECIFICATIONS FOR FIRE/SMOKE DAMPER PRODUCT INFORMATION.
4. FIRE/SMOKE DAMPER CIRCUITING IS SHOWN ON DRAWINGS E300, E301, E302. THIS DRAWING SHOWS DAMPER LOCATION ONLY.
5. PROVIDE ONE (1) DUCT SMOKE DETECTOR FOR EACH EXISTING AIR HANDLING UNITS (TWO AHU'S). FINAL QUANTITY, LOCATION AND ELECTRICAL REQUIREMENTS FOR DUCT SMOKE DETECTORS ARE TO BE CONFIRMED AND COORDINATED WITH THE MECHANICAL CONTRACTOR ON SITE PRIOR TO COMMENCING THE WORK.
6. ADD NEW FIRE ALARM DEVICES ON EXISTING CIRCUIT WITHIN THE AREA. PROVIDE FIRE ALARM VERIFICATION.
7. NURSE CALL SYSTEM TO MATCH RAULAND 5000 SERIES, COORDINATE WITH THE SUPPLIER, "LOGICAL SOLUTIONS", FOR ALL SYSTEM DEVICES REQUIRED TO CONNECT TO NURSE CALL HEADEND IN MEDICAL IMAGING DEPARTMENT.

NETWORK CABLING SHALL BE IN CORRIDOR CABLE TRAY OR NEW CONDUIT. CONTRACTOR TO CONFIRM ON SITE FOR EXISTING CABLE TRAY AVAILABILITY. PROVIDE 15A 120V ESSENTIAL POWER SUPPLY AS REQUIRED. SYSTEM TO MATCH EXISTING HOSPITAL NURSE CALL FUNCTIONS. SYSTEM TO INCLUDE STAFF EMERGENCY STATIONS, PATIENT STATIONS, DOME LIGHTS, WASHROOM ROOM PULL CORD STATIONS, AND MASTER STATION CONSOLE.

PROVIDE SHOP DRAWING FOR APPROVAL.

8. ACCESS CONTROL DEVICES TO BE WIRED TO EXISTING KANTECH SYSTEM. ORIGIN POINT TO BE DATA CLOSET "1CC1" IN ROOM NUMBER 1597 UNLESS OWNER INDICATES OTHERWISE. COORDINATE WITH OWNER ON SITE FOR EXACT REQUIREMENTS. COORDINATE WITH DOOR HARDWARE SUPPLIER FOR ADDITIONAL REQUIREMENTS.

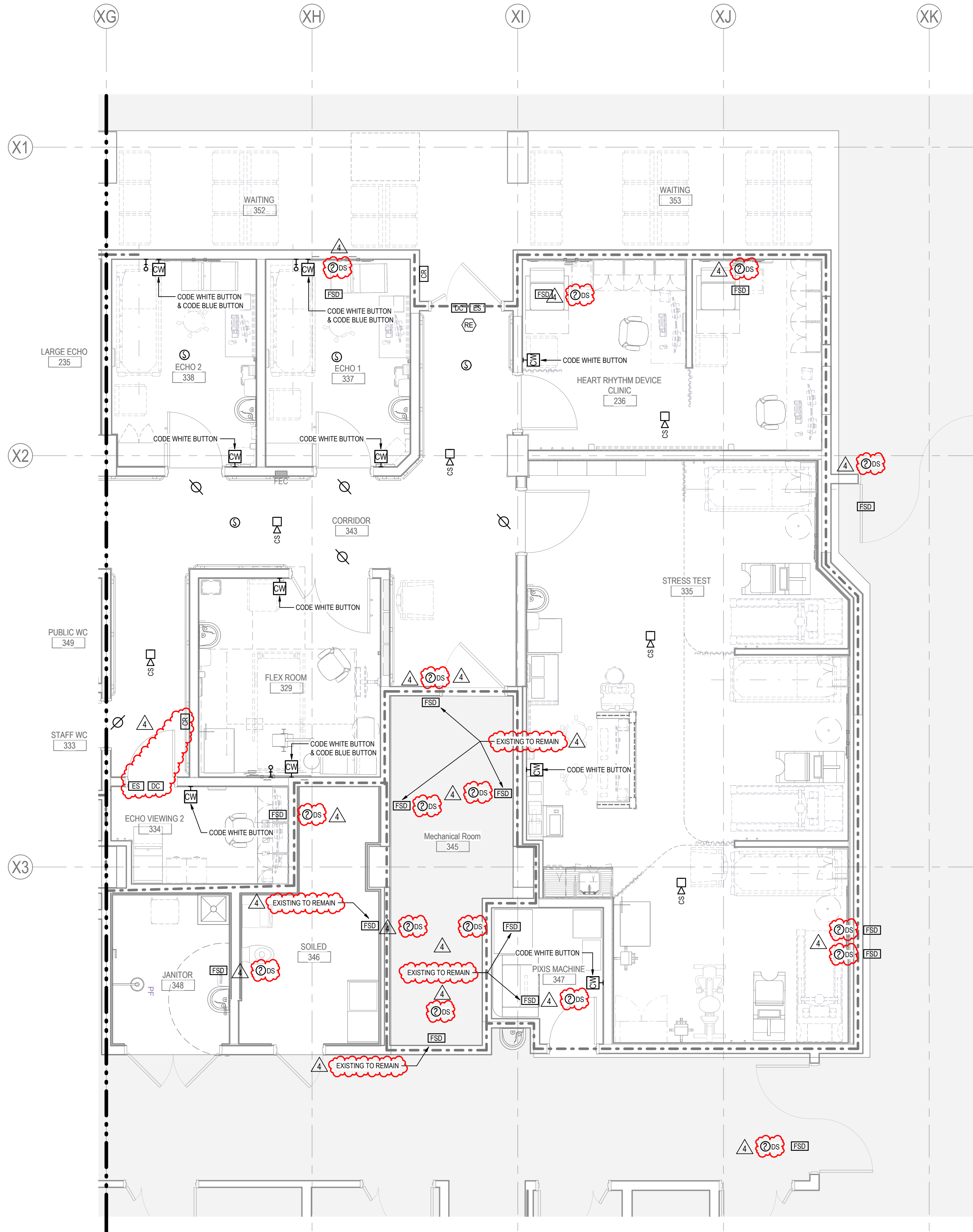

1 LEVEL 1 - NEW FIRE ALARM, ACCESS CONTROL AND NURSE CALL SYSTEM PLAN - EAST SIDE

1 : 50

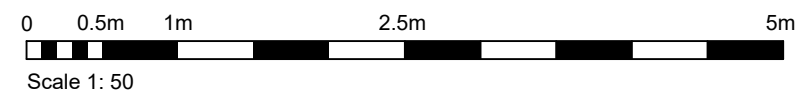

Stantec Consulting Ltd.
1100-111 Dunsmuir Street
Vancouver, BC V6B 6A3
Tel: (604) 696-8000 • www.stantec.com

Copyright Reserved

The Contractor shall verify and be responsible for all dimensions. DO NOT scale the drawing - any errors or omissions shall be reported to Stantec without delay.
The Copyrights to all designs and drawings are the property of Stantec. Reproduction or use for any purpose other than that authorized by Stantec is forbidden.

Consultant

Notes

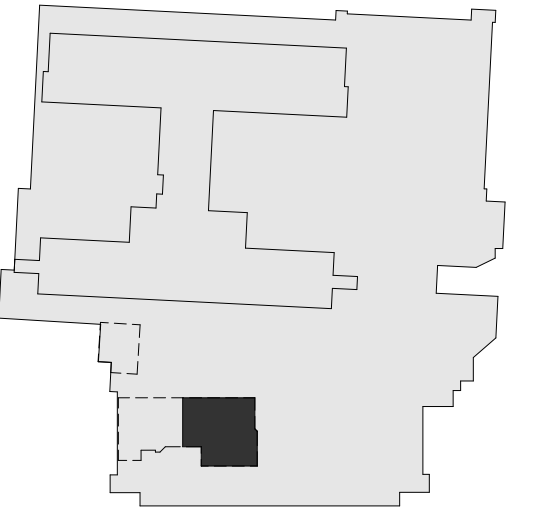

4	ISSUED FOR ADDENDUM 2	CC	TF	2025.02.21
3	ISSUED FOR BP	CC	TF	2025.02.05
2	ISSUED FOR TENDER	CC	TF	2025.01.27
1	ISSUED FOR 100% & QS	CC	CC	2024.11.24
Issued/Revision		By	Appd	YYYY.MM.DD

File Name: N/A
Dwn. Dsgn. Chkd. YYYY.MM.DD

Permit/Seal

Client/Project Logo



Client/Project
Northern Health

UHN - Cardiac Diagnostic Services - Phase 3

1475 Edmonton St, Prince George, BC V2M 1S2

Title
LEVEL 1 - FIRE ALARM, ACCESS
CONTROL & NURSE CALL SYSTEM
NEW - EAST SIDE

Project No.
144320012
Revision
4

Scale
As indicated
Drawing No.
E310

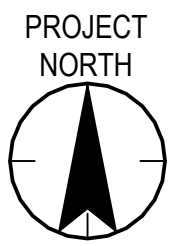

GENERAL NOTES

1. REFER TO NOTES ON DRAWING E001 AND E310.



Stantec Consulting Ltd.
1100-111 Dunsmuir Street
Vancouver, BC V6B 6A3
Tel: (604) 696-8000 • www.stantec.com

Copyright Reserved

The Contractor shall verify and be responsible for all dimensions. DO NOT scale the drawing - any errors or omissions shall be reported to Stantec without delay.
The Copyrights to all designs and drawings are the property of Stantec. Reproduction or use for any purpose other than that authorized by Stantec is forbidden.

Consultant

Notes

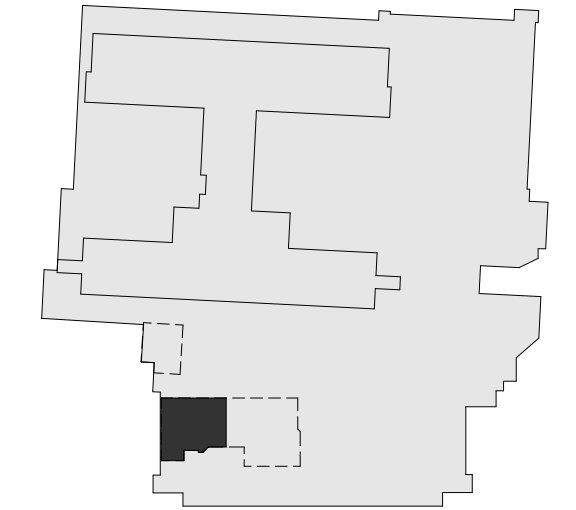

4	ISSUED FOR ADDENDUM 2	CC	TF	2025.02.21
3	ISSUED FOR BP	CC	TF	2025.02.05
2	ISSUED FOR TENDER	CC	TF	2025.01.27
1	ISSUED FOR 100% & QS	CC	CC	2024.11.24
Issued/Revision		By	Appd	YYYY.MM.DD

File Name: N/A
Dwn. Dsgn. Chkd. YYYY.MM.DD

Permit/Seal

Client/Project Logo



Client/Project
Northern Health

UHN - Cardiac Diagnostic Services - Phase 3

1475 Edmonton St, Prince George, BC V2M 1S2

Title
LEVEL 1 - FIRE ALARM, ACCESS
CONTROL & NURSE CALL SYSTEM
NEW - WEST SIDE

Project No.
144320012
Revision
4
Scale
As indicated
Drawing No.
E311

0 0.5m 1m 2.5m 5m
Scale 1: 50



1 LEVEL 1 - NEW FIRE ALARM, ACCESS CONTROL AND NURSE CALL SYSTEM PLAN - WEST SIDE

E311 1: 50

1. REFER TO GENERAL NOTES ON DRAWING E001.
2. PER CSA Z32, ALL PATIENT BEDS MUST HAVE 750 LUX DELIVERED AT BED SURFACE.

Stantec Consulting Ltd.
1100-111 Dunsmuir Street
Vancouver, BC V6B 6A3
Tel: (604) 696-8000 • www.stantec.com

The Contractor shall verify and be responsible for all dimensions. DO NOT scale the drawing - any errors or omissions shall be reported to Stantec without delay. The Copyrights to all designs and drawings are the property of Stantec. Reproduction or use for any purpose other than that authorized by Stantec is forbidden.

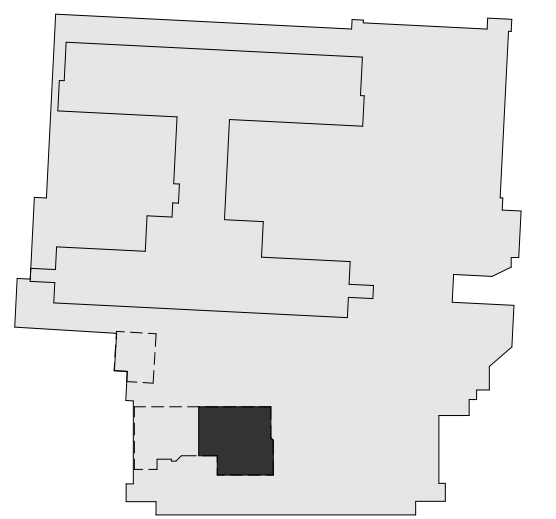

4	ISSUED FOR ADDENDUM 2						
4	ISSUED FOR RP	CC	Tf			2025-02-21	
2	ISSUED FOR TENDER	CC	Tf			2025-02-06	
		CC	Tf			2025-01-27	
	ISSUED FOR 100% & QS	CC	Cc			2024-11-26	
Issued/Revision		By	Appd			YYYY.MM.DD	

File Name: N/A				
	Dwn.	Dsgn.	Chkd.	YYYY.MM.DD



Client/Project
Northern Health

UHN - Cardiac Diagnostic Services - Phase 3

1475 Edmonton St, Prince George, BC V2M 1S2

LEVEL 1 - LIGHTING NEW - EAST SIDE

Project No. 144320012	Scale As indicated
Revision 4	Drawing No. E320



1 E320 **LEVEL 1 - NEW LIGHTING PLAN - EAST SIDE**

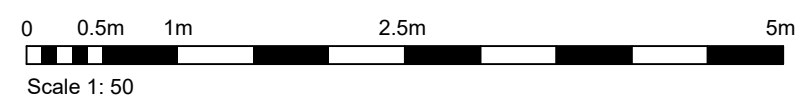



Copyright Reserved

The Contractor shall verify and be responsible for all dimensions. DO NOT scale the drawing - any errors or omissions shall be reported to Stantec without delay. The Copyrights to all designs and drawings are the property of Stantec. Reproduction or use for any purpose other than that authorized by Stantec is forbidden.

Consultant

Notes

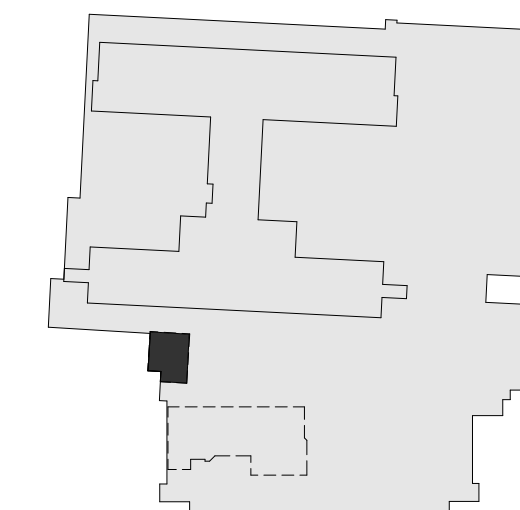
[illegible]

File Name: N/A				
	Dwn.	Dsan.	Chkd.	YYYY.MM.

Permit/Seal

Client/Project Logos



Client/Project
Northern Health

UHN - Cardiac Diagnostic Services - Phase 3

1475 Edmonton St, Prince George, BC V2M 1S2

Title
LEVEL 1 - LIGHTING NEW - NORTH SIDE

Project No. 144320012	Scale As indicated
Revision 4	Drawing No. E322



1. REFER TO NOTES ON DRAWING E001 AND E320.
2. EXIT SIGN SHOWN CAN BE CIRCUITED TO A CLOSER EXIT SIGN CIRCUIT IF A CIRCUIT IS AVAILABLE.

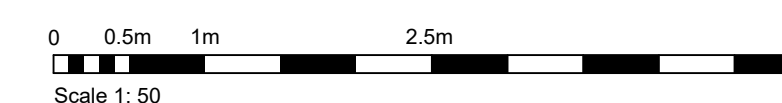







Click location in Project Information>
20 Feb 25 3:50:32 PM

ORIGINAL SHEET - ARCH D

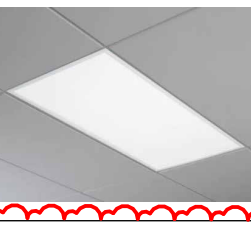
The Contractor shall verify and be responsible for all dimensions. DO NOT scale the drawing - any errors or omissions shall be reported to Stantec without delay. The Copyrights to all designs and drawings are the property of Stantec. Reproduction or use for any purpose other than that authorized by Stantec is forbidden.

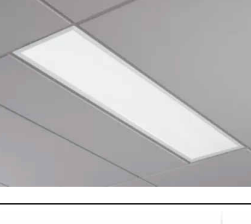
Notes

LUMINAIRE SCHEDULE												
TYPE	IMAGE	SIZE	DESCRIPTION	MOUNTING	WATTAGE	LUMEN OUTPUT	CRI	COLOR TEMP	VOLTAGE	MANUFACTURER	CATALOGUE #	REMARKS
A		4"	T-BAR OR OTHER CEILING TYPE.	RECESSED	16	1500	90	3500K	120	SIGNIFY	CALCULITE LED 4" SERIES 4RN/CAL15935MZ10U/C4RDLWH OR APPROVED EQUAL	REFER TO ARCH DRAWINGS FOR CEILING TYPES.
B		2'x2'	T-BAR CEILING TYPE.	RECESSED	39	4500	90	3500K	120	SIGNIFY	LEDALITE SILKSPACE 42-22-D1-ST-L-935-45-A-1-D-E OR APPROVED EQUAL	⚠
C		2'x4'	T-BAR CEILING TYPE.	RECESSED	33	4500	90	3500K	120	SIGNIFY	LEDALITE SILKSPACE 42-24-D1-ST-L-935-45-A-1-D-E OR APPROVED EQUAL	FOR USE IN INDICATED CORRIDORS.
C2		2'x4'	T-BAR CEILING TYPE.	RECESSED	44	6000	90	3500K	120	SIGNIFY	LEDALITE SILKSPACE 42-24-D1-ST-L-935-60-A-1-D-E OR APPROVED EQUAL	FOR USE IN INDICATED PATIENT AREAS.
D		1'x4'	T-BAR OR DRYWALL CEILING TYPE.	RECESSED	38	4500	90	3500K	120	SIGNIFY	LEDALITE SILKSPACE 42-14-D1-ST-L-935-45-A-1-D-E OR APPROVED EQUAL	REFER TO ARCH DRAWINGS FOR CEILING TYPES. COORDINATE WITH LIGHTING SUPPLIER FOR DRYWALL MOUNTING ACCESSORIES OR EQUIVALENT.
E			T-BAR CEILING TYPE.	LINEAR PENDANT	28 / 4 FT	3500 / 4 FT	90	3500K	120	SIGNIFY	LEDALITE TRUGROOVE 29-0-6-L-935-35-QQ-08-D-E-1-N-NN	REFER TO ARCH DRAWINGS FOR CEILING HEIGHT. RECOMMEND MOUNTING AT 8 FT.
X1			GREEN RUNNING MAN	SURFACE WALL OR CEILING	2				120	EMERGILITE	TO MATCH GREEN RUNNING MAN EXIT SIGNS IN BUILDING. EMERGILITE ES SERIES OR APPROVED EQUAL.	PROVIDE DIRECTIONAL ARROWS AND FACES AS INDICATED ON THE PLANS.

MECHANICAL EQUIPMENT SCHEDULE																	
EQUIPMENT TAG	QUANTITY	UNIT DESCRIPTION	UNIT LOCATION	MOTOR DATA						POWER					NOTES		
				HP	FLA	kW	MCA	VOLTAGE	PHASE	BREAKER (A)	POLES	NO. OF WIRES	WIRE SIZE	CONDUIT SIZE (mm)			
HVAC																	
FSD	1	FIRE SMOKE COMBINATION DAMPER	REFER TO MECH DWG M101, M102, M103					120	1	15	1	2	#12	21	DUCT SMOKE DETECTORS REQUIRED. CIRCUITING NOTED ON ELEC DWG.		
PLUMBING																	
LAV-1	1	ELECTRONIC FAUCET FOR LAV-1 (SENSOR TYPE)	REFER TO MECH DWG					120	1	15	1	2	#12	21	HARDWIRED ELECTRONIC FAUCET. CIRCUITING NOTED ON ELEC DWG.		
WC-1	1	ELECTRONIC FLUSH VALVE (SENSOR TYPE)	REFER TO MECH DWG					120	1	15	1	2	#12	21	LINE POWERED WITH 24 VAC STEP DOWN TRANSFORMER.		
HHS-1	1	ELECTRONIC FAUCET FOR HHS-1 (SENSOR TYPE)	REFER TO MECH DWG					120	1	15	1	2	#12	21	HARDWIRED ELECTRONIC FAUCET. CIRCUITING NOTED ON ELEC DWG.		
HT	1	ELECTRIC HEAT TRACE (DOMESTIC HOT WATER TEMPERATURE MAINTENANCE SYSTEMS)	REFER TO MECH DWG					208	1	30	2	2	#12	21	RAYCHEM HWAT 140OF HWAT-R2 (RED). CIRCUITING NOTED ON ELEC DWG.		
CRBFS-1	1	CHILLED RECESSED BOTTLE FILLING STATION	REFER TO MECH DWG		5.0	0.37	6.3	120	1	15	1	2	#12	21	CIRCUITING NOTED ON ELEC DWG.		
MEDICAL GAS																	
MEDICAL GAS PANEL	1	MEDICAL GAS ZONE VALVE / AREA ALARM PANEL	REFER TO MECH DWG					120	1	15	1	2	#12	21	CIRCUITING NOTED ON ELEC DWG.		

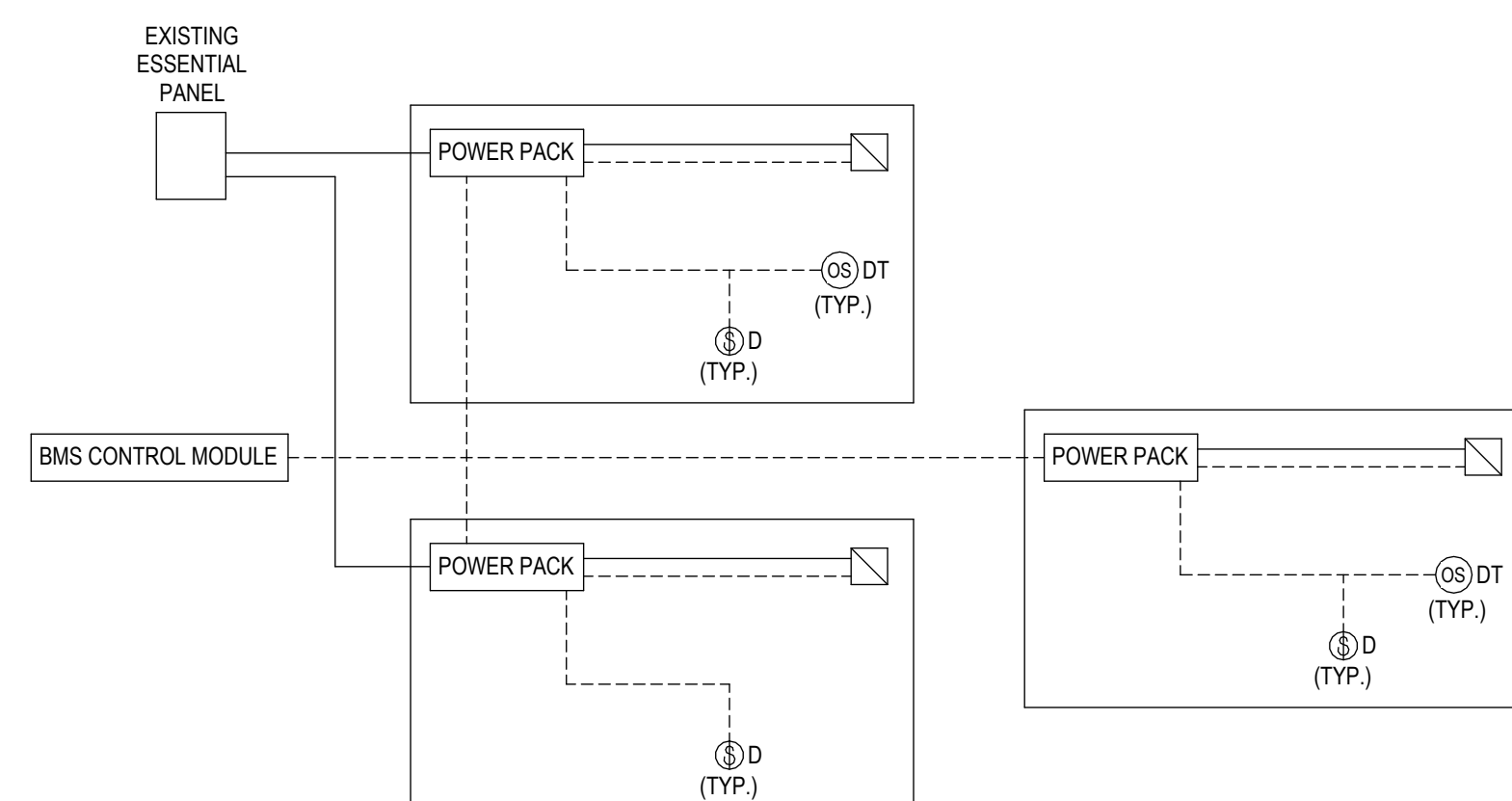

1. PROVIDE POWER PACK, DIMMER SWITCH AND OCCUPANCY SENSOR TO MATCH EXISTING LIGHTING CONTROL SYSTEM (RELIABLE CONTROLS).

2. LIGHTING CONTROL BEHAVIOR:
 - a. PATIENT ROOMS: MANUAL ON/OFF, DIMMABLE.
 - b. OFFICES, CORRIDOR: AUTO ON/OFF, DIMMABLE.
 - c. STORAGE: AUTO ON/OFF.

EMERGENCY CIRCUIT LIGHTING TO BYPASS LOCAL CONTROL DURING OUTAGE, AND TURNS LIGHTS ON AT FULL BRIGHTNESS. PROVIDE EMERGENCY LIGHTING REMOTE TEST SWITCH.

3. PROVIDE REMOTE TEST SWITCH FOR CONNECTION TO POWER PACK

4. DIMMING WILL BE 0-10V

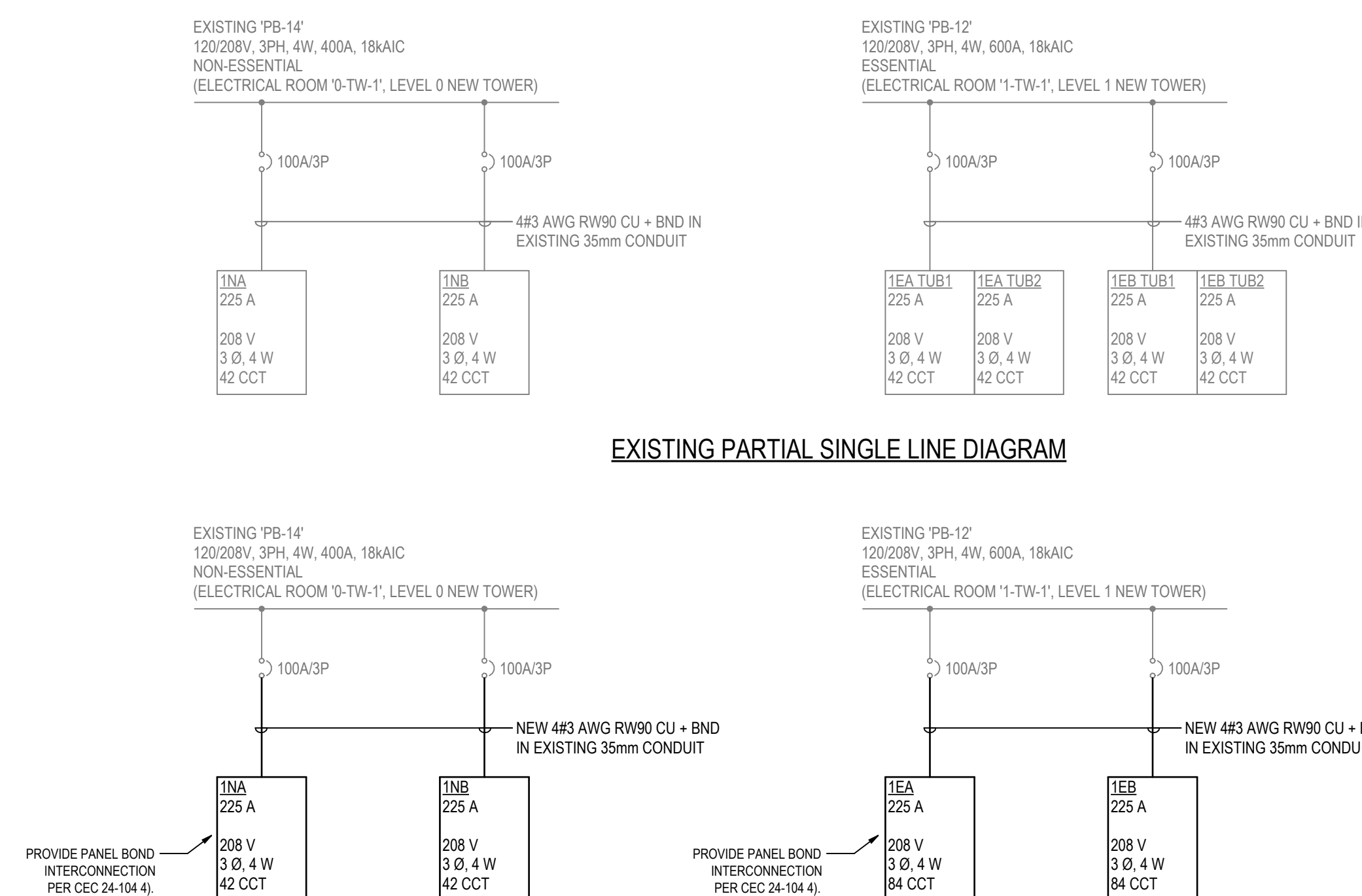

NEW PARTIAL SINGLE LINE DIAGRAM

E400 N.T.S

Client/Project
Northern Health

UHN - Cardiac Diagnostic Services - Phase 3

1475 Edmonton St, Prince George, BC V2M 1S2

Title
ELECTRICAL SCHEDULES & DIAGRAMS
(1 OF 2)

Project No.
144320012Revision
4

Scale
N.T.S.

Drawing No.
E400